

LY-S1 (1000mm drop)  
LY-S2 (2000mm drop)

---

INSTRUCTION MANUAL FOR

## **Motorized Projector Lift**

---

*Lyft* systems

## Parts list:

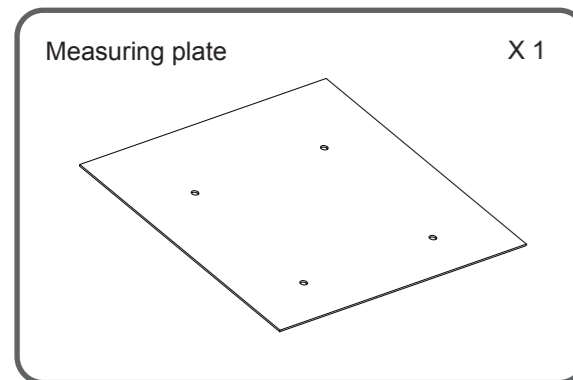
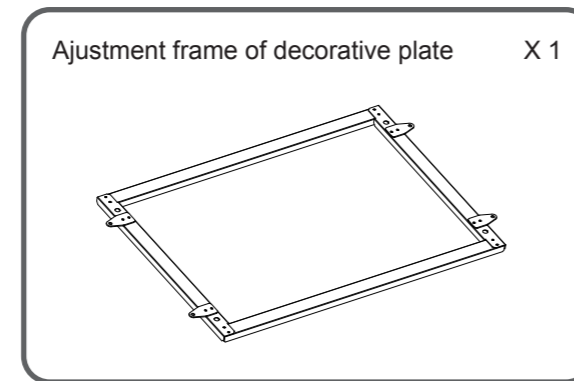
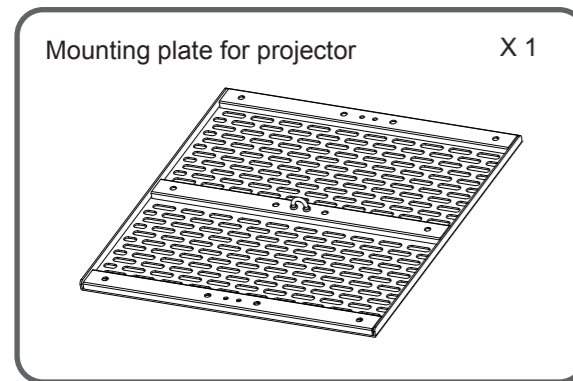
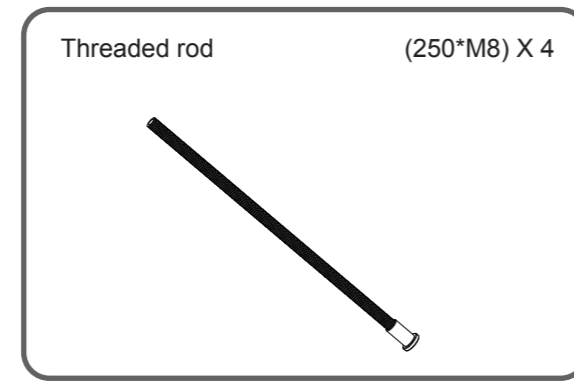
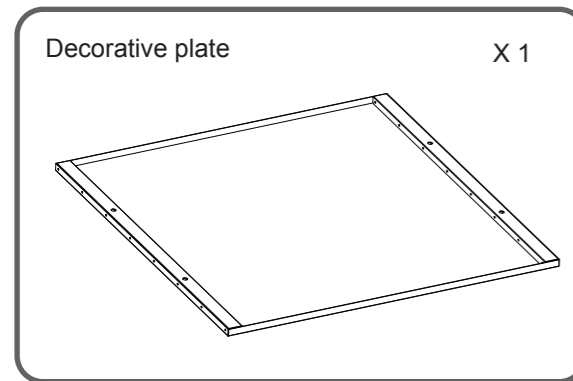
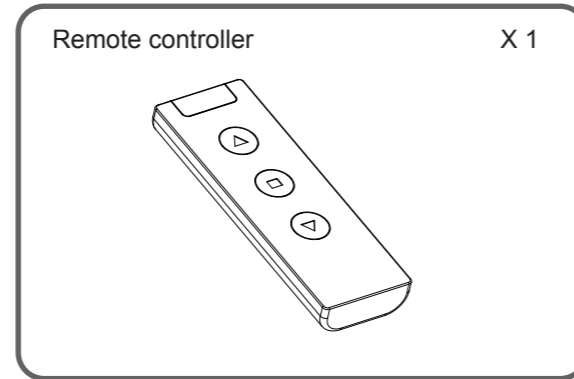
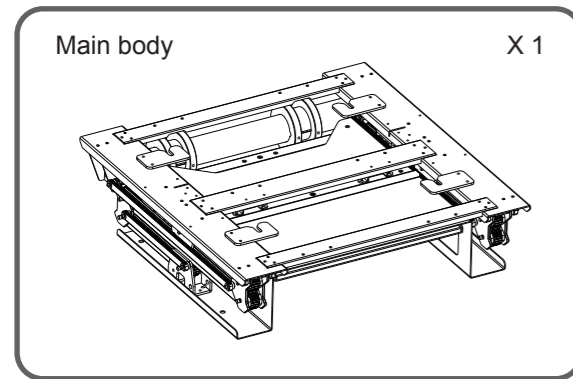

Main parts are as above, below are accessories:

1. Hexagon screw M4\*20 (X4)
2. Metal washer 20\*1.5 (X8)
3. Allen key (X2)
4. Allen key for motor adjustment (X1)
5. Power cord (X1)
6. EPE foam (X1)

## Profile

LY Series is our latest design and with strict production control and quality inspection product. It has a good outlook appearance and easy installation. It's a best choice for professional projectors.

## Performance

1. Ultra thin body design to meet up with narrow installation place.
2. Smooth performance with low noise.
3. Overheat protection function.
4. Easy cabling installation.

## Specifications

Model.	Spec.	Body size (mm)	Arm (Section)	Travel distance (mm)	Decorative plate (mm)	Load (kg)	Projector size (mm)	Distance from ceiling to false ceiling(mm)
LY-S1		730*730*223.5	3	223.5-1020	724*724	40	500*600*240	250-850
LY-S2		730*730*315.5	5	315.5-1910	724*724	40	500*600*240	350-1700

## Operating environment for indoor use only:

1. Temperature: -10°C --- +40°C
2. RH: <95%
3. Environment with non-corrosive gas
4. Environment without organic aerosol inflammable and explosive gas
5. Voltage: 100V / 220V (±10%)
6. Avoid violent vibration and collision

## Installation steps:

1. Based on the screen size and the projector's focal distance to set the installation place, use the measuring plate to mark underline on the false ceiling.
2. Cut out the holes as above underline.
3. Take out the cut board for later using.
4. Mark out 4 locations where the expansion screws should locate on the ceiling by the measuring board.
5. Drilling out those 4 holes as the marks.
6. Screw an expansion screw into each hole.
7. Loose those 6 screws of the dustproof cover, and take the dustproof cover out.
8. Loose the screws and take the arms from the main body.
9. Install the body frame onto the ceiling.
10. Reassemble the arms into the body frame, clip the straps on the arms and lower the arms slowly.
11. Install the necessary cables such as HDMI.
12. Reassemble the dustproof cover back to the arms.
13. Fix the projector onto the mounting plate.
14. Hang the projector on the hook of the dustproof cover and fasten the screw on top of the cover.
15. Use those four screws in the corners of the dustproof cover to adjust the desired angle of the projector.
16. Turn the projector lift on and set up the UP and DOWN limits.
17. Assemble the ajustment frame. Adjust the threaded rods to balance the frame with the false ceiling.
18. Install the decorative plate.

Installation Diagram:

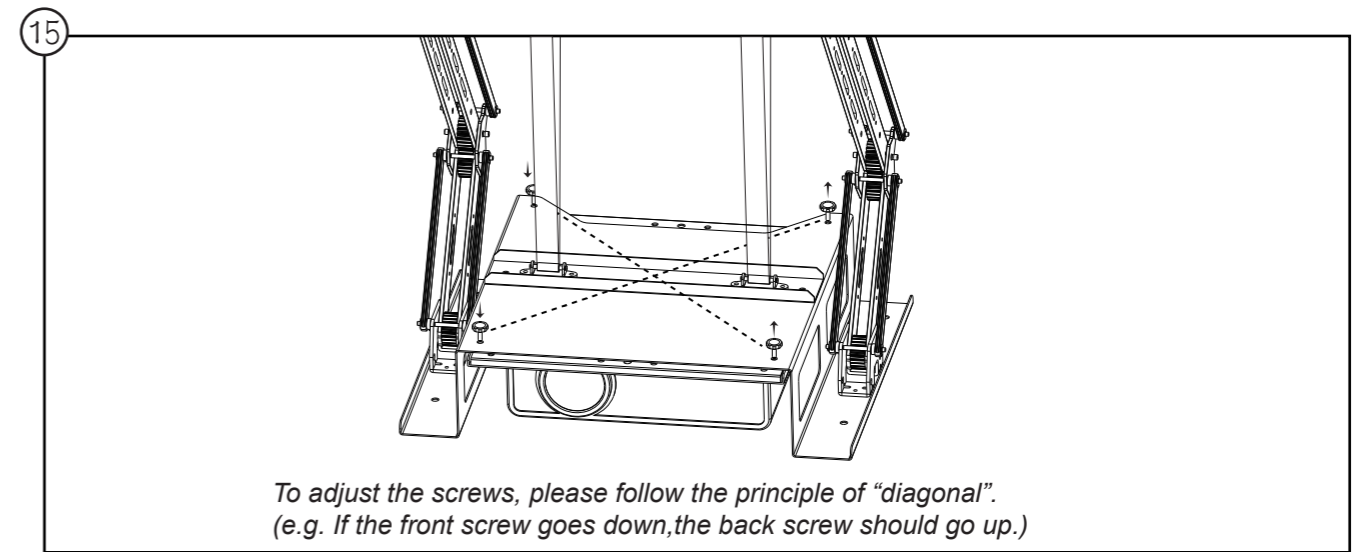
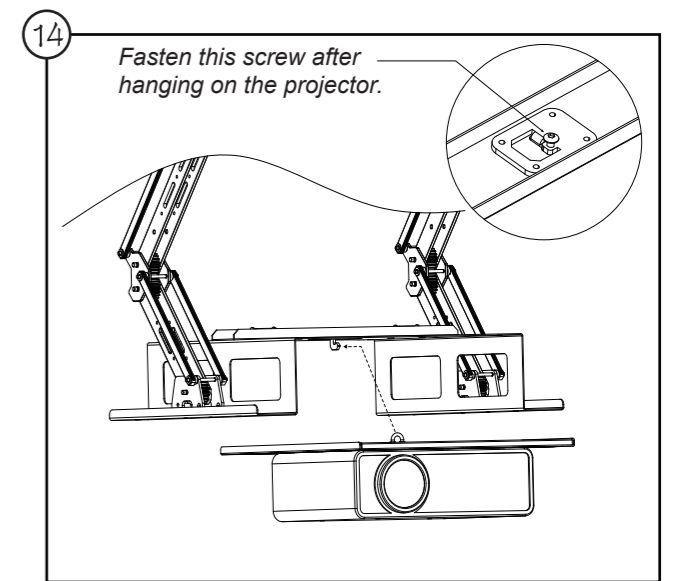
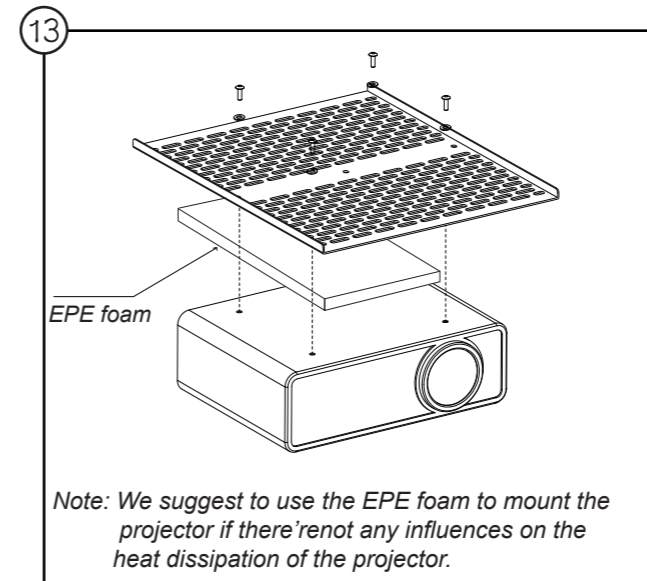
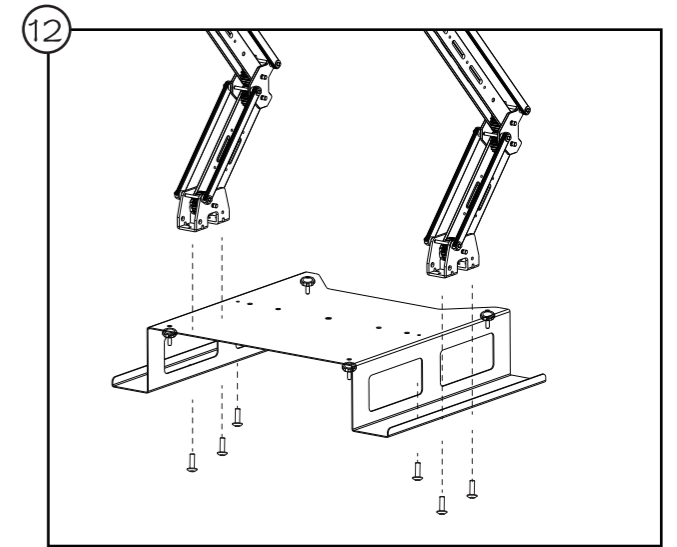
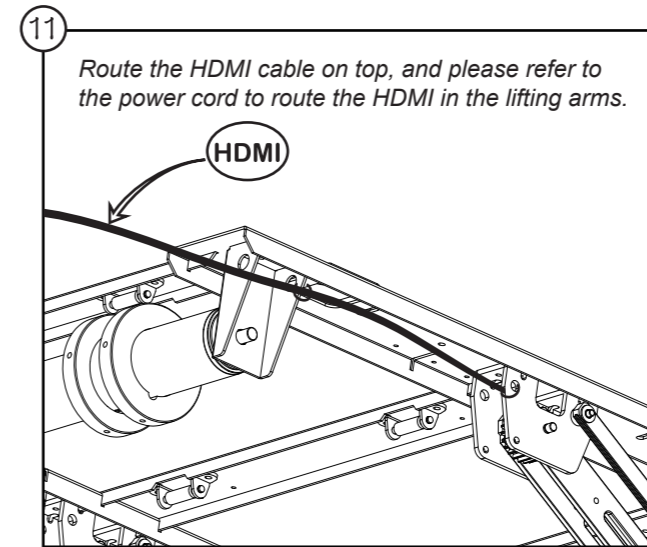
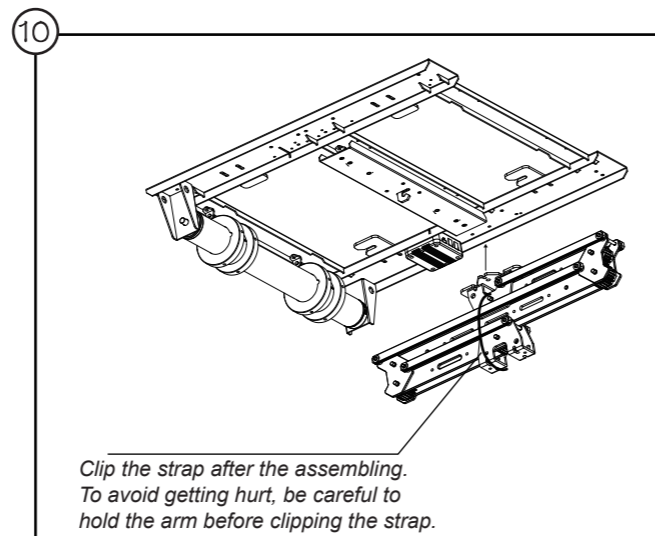
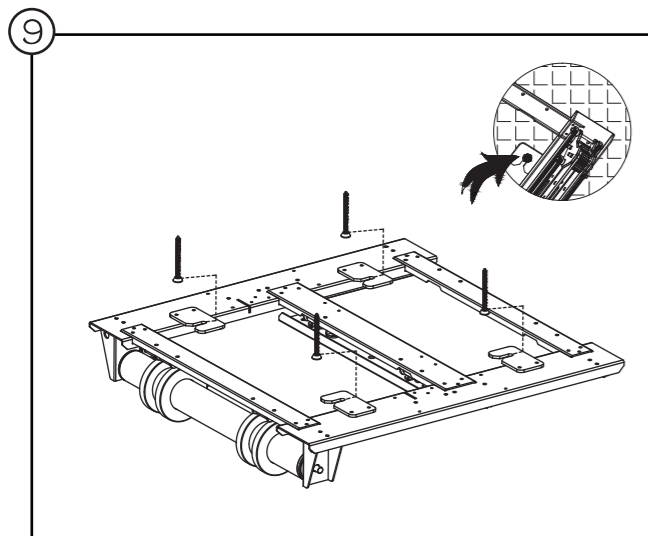
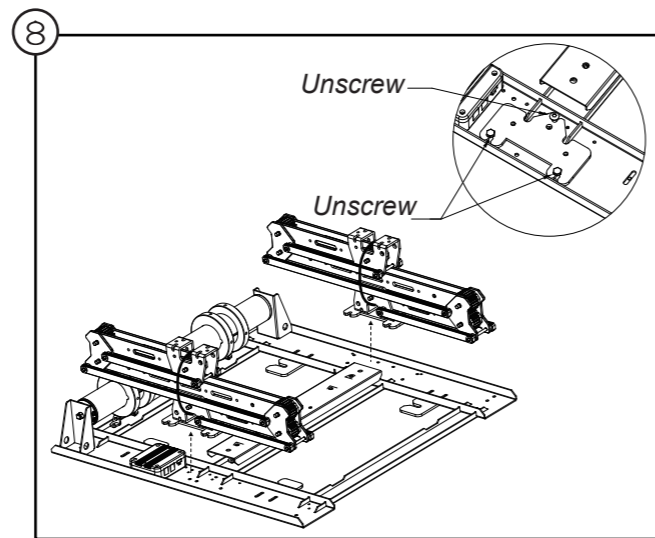
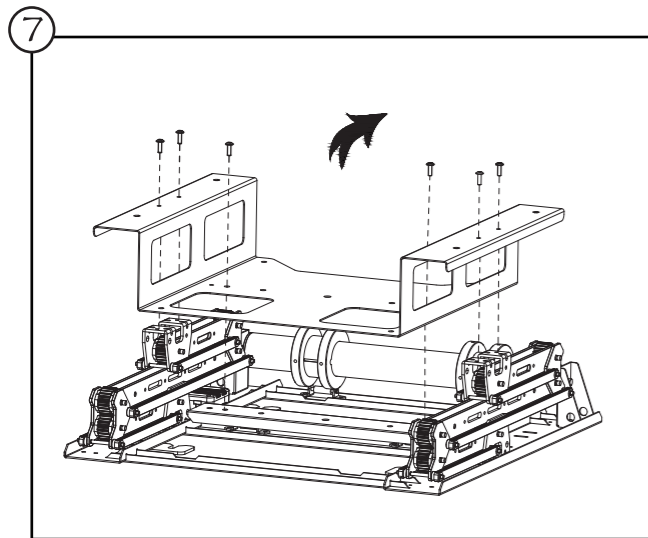
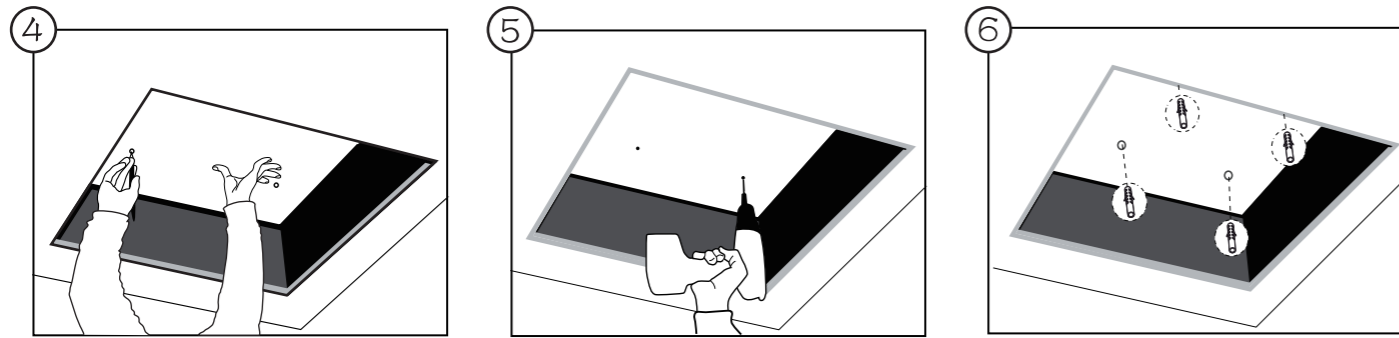
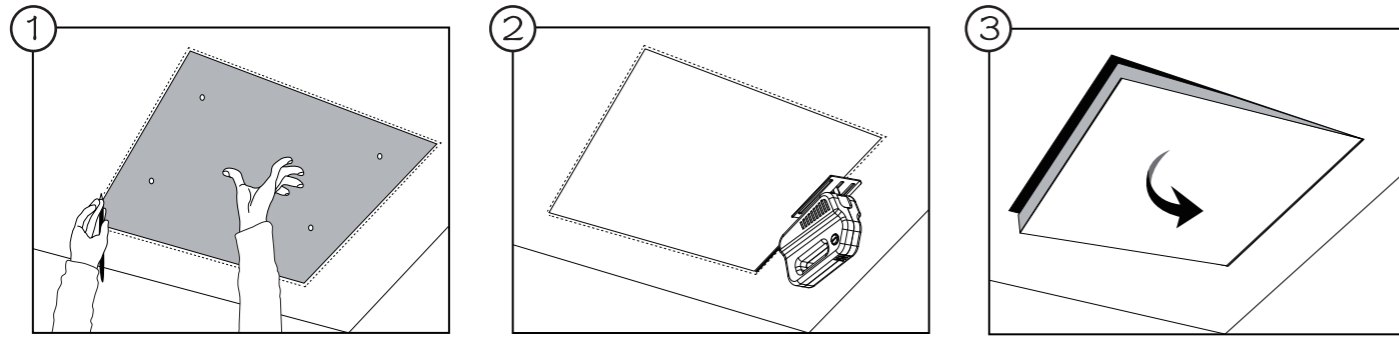

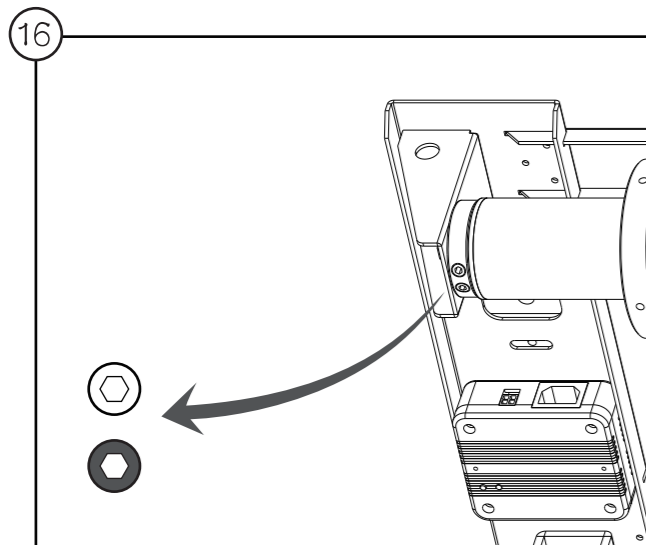
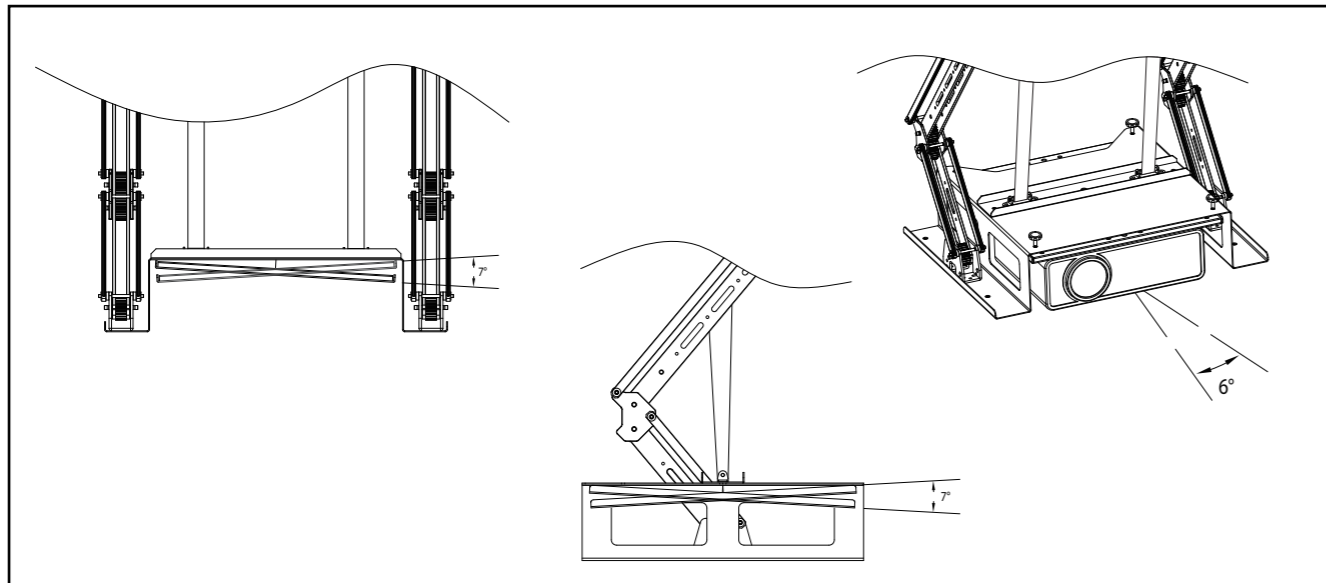

★ **White adjustment for DOWN limit**  
 Anticlockwise - increase the length of moving down.  
 Clockwise - reduce the length of moving down.  
 Caution: If it's in the DOWN limit statement, do not turn clockwise.

★ **Red adjustment for UP limit**  
 Anticlockwise - increase the length of moving up.  
 Clockwise - reduce the length of moving up.  
 Caution: If it's in the UP limit statement, do not turn clockwise.

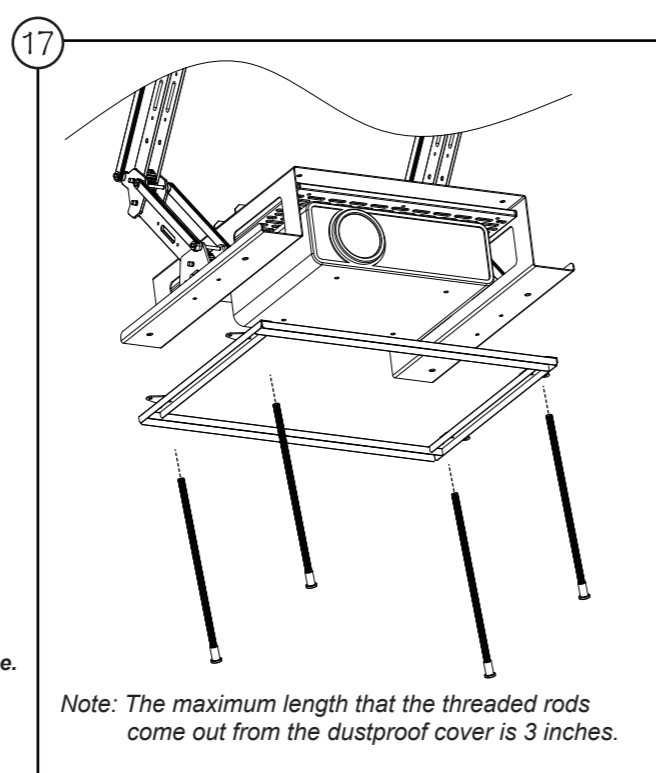

Note: The maximum length that the threaded rods come out from the dustproof cover is 3 inches.

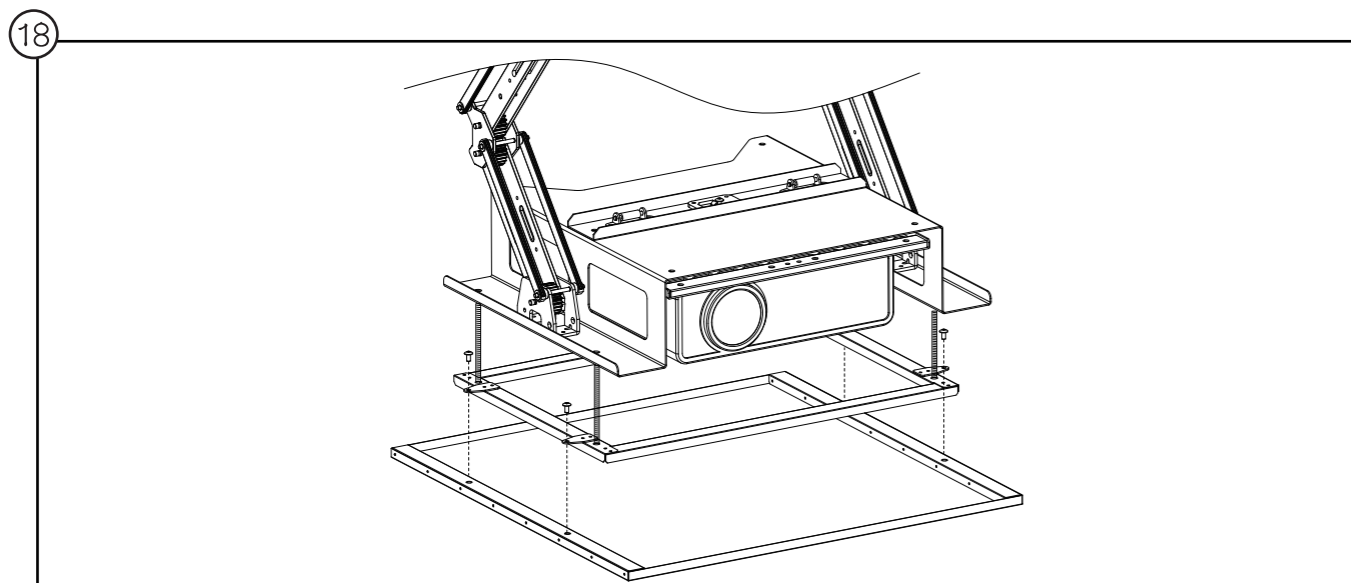

## Precautions for use:

Please refer to below procedures to check if the projector lift is out of order.

1. Make sure the power cord connected properly and be with regular power supply.
2. Do not operate it frequently.
3. Let the motor stop for 15 minutes, then turn it on again to check if the motor is in an overheating protection statement. If the problem still remains unsolved, please contact with us or the dealers for further assistance. Please do not disassemble or change the structure by your own.

## Troubleshooting:

We only recommend experienced AV installers undertake these procedures:

If the projector lift does not work

1. Restart it after 15 minutes to check if it's in overheating protection statement or not.
2. Check both terminals of the power cord to see if the problem occurs by the power supply.
3. If the voltage is normal, please check if there're any loose wires or burned fuse occurred.

## Control System

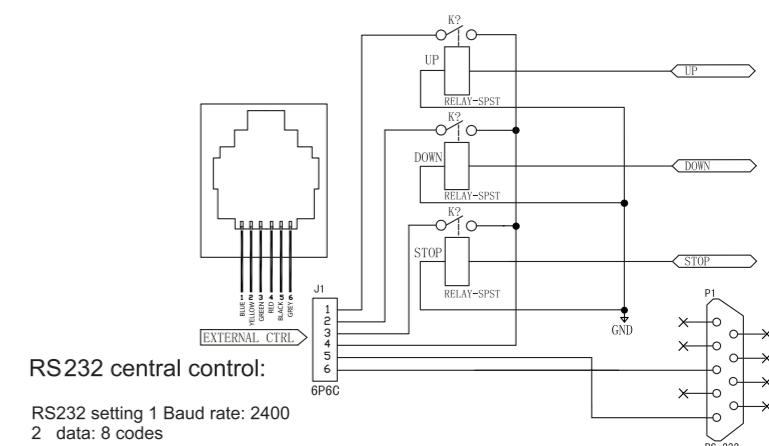
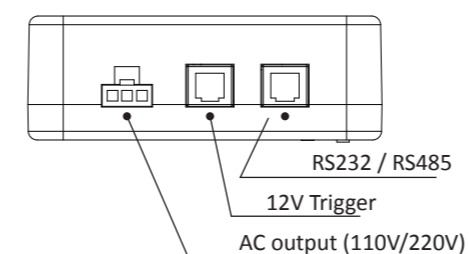
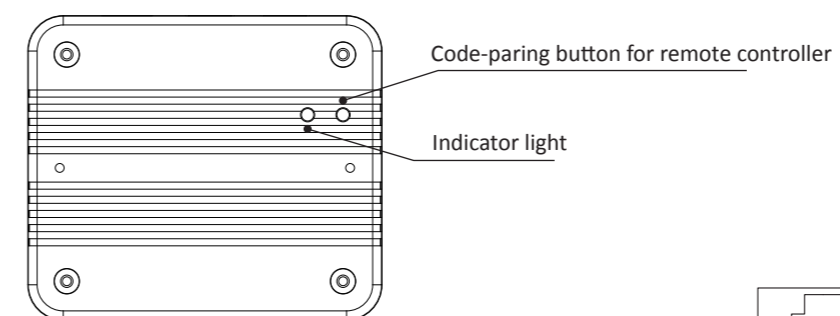
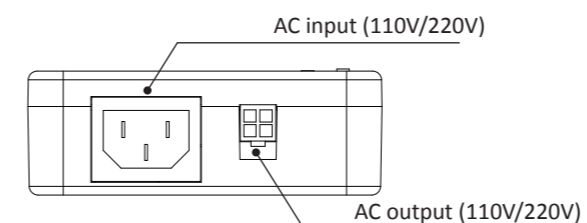

RS232 central control:

RS232 setting 1 Baud rate: 2400  
 2 data: 8 codes  
 4 start: 1  
 5 stop: 1  
 For up: 0xFF,0xEE,0xEE,0xEE,0xDD  
 For down: 0xFF,0xEE,0xEE,0xEE,0xEE  
 For stop: 0xFF,0xEE,0xEE,0xEE,0xCC

IR code

For "UP": 0xD2,0x01,0xEE,0xC1  
 For "STOP": 0xD1,0x01,0xCC,0x9E  
 For "DOWN": 0xD0,0x81,0xDD,0x2E